

Switchex®

LED DRIVER + DIMMER IN ONE

SWITCHEX® is a dimmer with an integrated driver that converts 120VAC to either 12VDC or 24VDC. This means SWITCHEX® is all you need between your line voltage and low voltage LED lighting. Best of all, it fits in a standard electrical box.

- SWITCHEX® solves two of the most common LED lighting challenges:
- Poor dimming performance that often results when a dimmer and LED driver are made by different manufacturers
 - Finding a place to fit the LED driver



The Driver Is Inside

SWITCHEX® is all you need between your line voltage and low voltage LED lighting. The integrated driver converts 120VAC to either 12VDC or 24VDC and it fits in a standard electrical box.

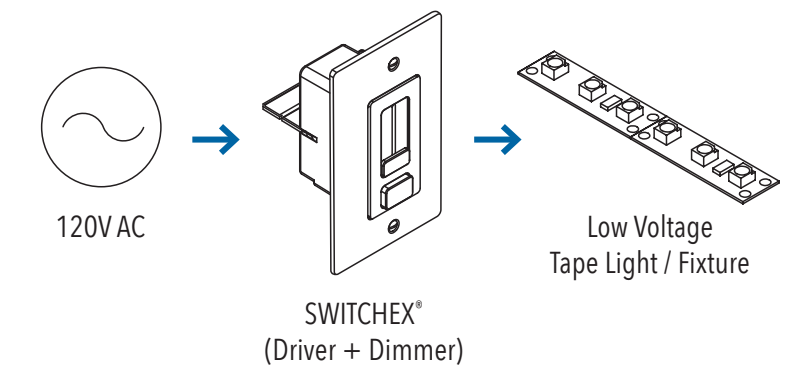
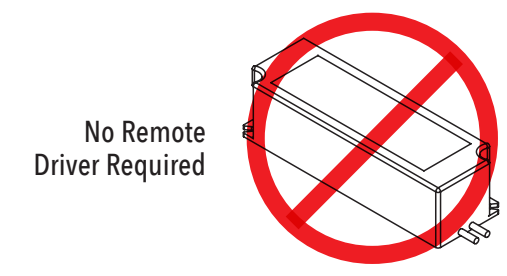

FEATURES

- Eliminates driver/switch compatibility issues
- Easy in-line installation
- Integrated LED driver
- Excellent dimming performance
- Fits in a standard electrical box
- Preset dimmer with on/off switch
- 100W, 24V DC capacity
- 60W, 12V DC capacity (separate model)
- 2 year limited warranty

SPECIFICATIONS	
Electrical	SX-12V-DD-60W = 120V AC input, 12V DC output SX-24V-DD-100W = 120V AC input, 24V DC output
Environment	Indoor
Connection Type	Hardwire
Mounting	Single-Gang Box
Approvals	UL Listed 2108

SWITCHEX® Driver and Dimmer Switch Diagram

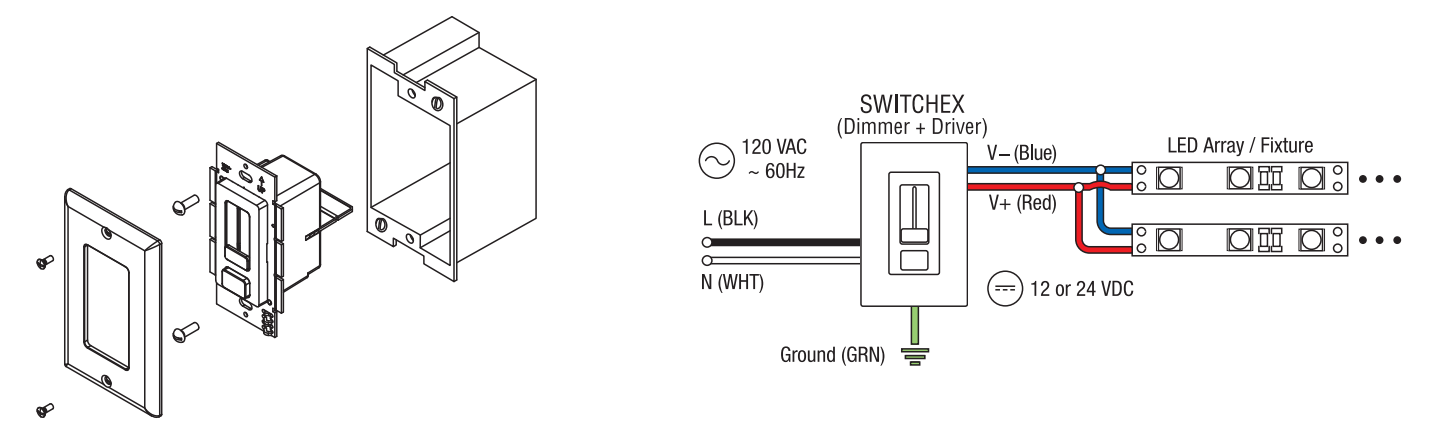

PRODUCT CODES

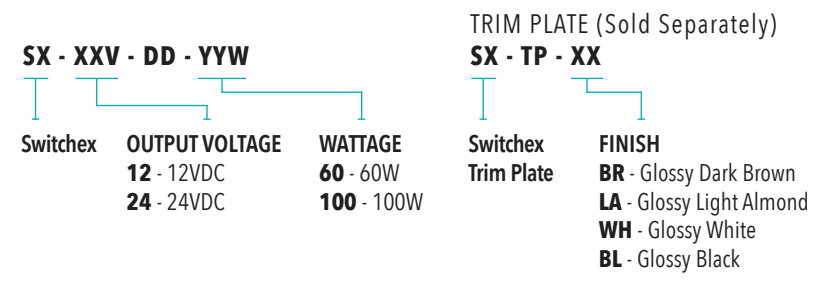

LED Drivers Selector Chart



Indoor, Non-Dimmable	LED Neon Flex	LED Mini Star II	LED Strip Series†	LED Globe Light	LED Wedge Light	LED Hard Strip	LED Thin Star	LED Britestrip	LED eSTRIP	LED Disc Light	LED MiniDisc Light
LEDDR-12-20W-HW 12V, 20W, hardwire in junction box, Max. 20W	-	-	-	-	Max. 80 Globes	-	-	-	-	Max. 6 LEDD	Max. 75 LEDMD
MLDR-18-24P 24V, 18W, plug in	-	Max. 4 LEDMS II	-	-	-	-	-	-	-	-	-
LEDSH-24-20W-HW 24V, 20W, hardwire in junction box, Max. 20W	-	-	-	-	-	-	Max. 30 Thin Star LEDs	-	-	-	-
MLDR-20-24JB 24V, 20W, hardwire in junction box, Max. 20W	Max 7.3' (2.2m) LED Neon Flex	Max. 4 LEDMS II	Max. recommended load 18W or 4' (1.22m) LED Strip Series 6' (1.83m) CCT Series	Max. 60 Globes	-	Max. recommended load 18W LED Hard Strip	-	Max. 38 LED lamps	Max. 18' (5.4m) LED eSTRIP Max. 8' (2.4m) HP LED eSTRIP	-	-
MLDR-60-24P 24V, 60W plug in	-	Max. 16 LEDMS II	-	-	-	-	-	-	-	-	-
LEDTS-24-65 24V, 60W, plug in	-	-	-	-	-	-	Max. total 60 Thin Star LEDs*	-	-	-	-
Indoor/Outdoor Non-Dimmable											
LEDDR-12-60W 12V, 60W, hardwire, outdoor, Max. 60W	-	-	-	-	Max. 200 Globes	-	-	-	-	Max. 18 LEDD	Max. 200 LEDMD
MLDR-120-24 24V, 120W, hardwire, outdoor, Max. 120W	Max 40' (12.1m) per single tap, Max 48' (14.6m) combined 2 secondary taps	Max. 32 LEDMS II 16 per single secondary tap	LED Strip Series: Max. recommended load 90W or 20' (6.1m) per single tap, 120W or 27' (8.53m) combined two secondary taps. CCT series: 16' (4.88m) per single tap, 20'(6.1m) combined two secondary taps.	Max. 180 Globes per single tap, max. 120 combined two secondary taps.	-	-	-	Festoon .52W LED modules: Max. 110 per single secondary tap, max. 185 total	Max. 90' (27.43m) per single secondary tap, max. 120' (36.58m) combined two secondary taps. RGB eStrip & HP eStrip: 40' (12.1m) per single secondary tap, 50' (15.24m) combined secondary taps	-	-
Indoor/Outdoor Dimmable											
MLDRE-20-12-DM†† 12V, 20W, hardwire, outdoor, dimmable, Max. 18W, Min. 10W	-	-	-	-	Max. 80 Globes	-	-	-	-	Max. recommended load 18W or 6 LEDD Min. recommended load 8W or 3 LED Disc Lights	Max. 75 LEDMD Min. recommended load 8W or 34 LED MiniDisc Lights
MLDRE-60-12-DM†† 12V, 60W, hardwire, outdoor, dimmable, Max. 54W, Min. 30W	-	-	-	-	Max. 200 Globes	-	-	-	-	Max. recommended load 54W or 18 LEDD Min. recommended load 8W or 3 LED Disc Lights	Max. 200 LEDMD Min. recommended load 8W or 34 LED MiniDisc Lights
MLDRE-40-24-DM†† 24V, 40W, hardwire, outdoor, dimmable, Max. 36W, Min. 20W	Max 14.5' (4.4m) Min 8 watts, 3.3' (1m) LED Neon Flex	Max. 10, Min. load 10W or 3 LED Mini Star II	LED Strip Series: Max. recommended load 36W or 8' (2.44m), Min. 8W or 2' (.61m).	Max. 80 Globes	-	Max. recommended load 36W, min. 8W LED Hard Strip	Max. total 60 Thin Star LEDs* Min. recommended load 8W or 18 Thin Star LEDs	Max. 76 LED lamps Min. 16 LED lamps	LED eStrip: Max. 37.5' (11.43m), Min. 8W, 9' LED eStrip (2.44m). High Power: Max. 18' (5.49m), Min. 4' (1.2m)	-	-
MLDRE-96-24-DM†† 24V, 100W, hardwire, outdoor, dimmable, Max. 90W, Min. 50W	Max 40'(12.1m) Min 8 watts, 3.3' (1m) LED Neon Flex	Max. 25, Min. load 10W or 3 LED Mini Star II	LED Strip Series: Max. recommended load 90W or 20' (6.1m), Min. 8W or 2' (.61m).	Max. 180 Globes	-	Max. recommended load 90W, min. 8W LED Hard Strip	-	Max. 180 LED lamps Min. 16 LED lamps	LED eSTRIP: Max. 90' (27.4m), Min. 8W, 9' LED eStrip (2.44m). High Power: Max. 40' (12.19m), Min. 4' (1.2m)	-	-

† Note: Above maximum and minimum lengths are for LP-5060-60 series. You may double these when using LP-5060-30 series.
 †† MLDRE drivers require E-KO-SR for outdoor applications

* Please refer to catalogue for # of LEDs per fixture.