

# LED Hard Strip RGB

LED Hard Strip RGB is a energy efficient linkable linear strip in an aluminum casing. These LEDs are cool to the touch and provide 120° beam spread. Available in 3 sizes.



## FEATURES

- Use high brightness 0.5W SMD PLCC-2 LEDs as lighting source
- Even light distribution with 120° viewing angle
- 24V DC
- 3 sizes - 11.8" (300mm), 19.7" (500mm), 39.4" (1000mm)
- Convenient connector between two strips

## APPLICATIONS

- Under Counter
- Display Cases
- Cabinet Interiors
- Work Stations
- Linear interior decorative lighting



## SPECIFICATIONS

	LV-HS-RGB-24T2-1	LV-HS-RGB-24T2-2	LV-HS-RGB-24T2-3
Input Voltage (V DC)	24		
Power per strip	3.6W	6W	12W
LED Qty. per strip	18	30	60
Colour Temperature	RGB		
Viewing Angle	120°		
Size	300 x 16 x 21mm	500 x 16 x 21mm	1000 x 16 x 21mm

## MOUNTING OPTIONS

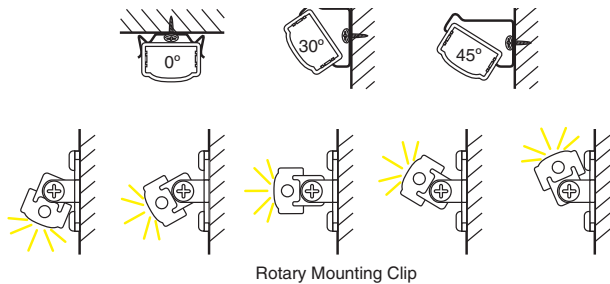

## PRODUCT CODES

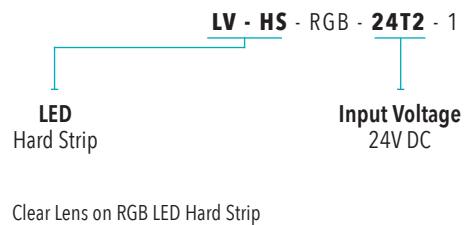

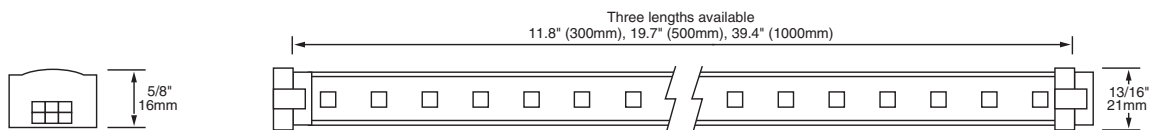

## ACCESSORIES



**LV-HS-PF2-HW**  
39" Power Feed for LED Hard Strip RGB, Bar - Hard wire power supply



**LV-HS-PC2-3**  
3" Power Connector for LED Hard Strip RGB, Bar - Bar



**LV-HS-PC2-12**  
12" Power Connector for LED Hard Strip RGB, Bar - Bar



**LV-HS-PC2-39**  
39" Power Connector for LED Hard Strip RGB, Bar - Bar



**LV-HS-EC**  
End Cap for LED Hard Strip

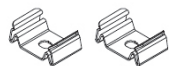

**LV-HS-MC0**  
Mounting clip (2pk)



**LV-HS-MC30**  
Mounting clip 30° (2pk)

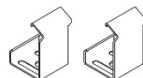

**LV-HS-MC45**  
Mounting clip 45° (2pk)

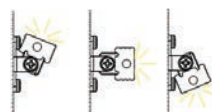

**LV-HS-MCTR**  
Rotary Mounting clip (2pk)



**LT-09S-RF**  
6 Key RGB "touch" controller 12/24V DC



**LN-CON-WIFI-3CH-XV**  
WiFi controller for RGB, c/w RF remote 12/24VDC



**LT-390A**  
Signal amplifier for RGB

## NON DIMMABLE PLUG IN DRIVERS

### LV-HSDR-36-24-PC

36W plug-in driver, 24V, DC Portable Driver, 1.5A output, 100V-240V input voltage; with six foot (72") power cord to polarized 2-prong AC plug and 60" lead wire to DC plug and switch cUL/us Listed

### LV-HSDR-60-24-PC

60W plug-in driver, 24V, DC Portable Driver, 2.5A output, 100V-240V input voltage; with six foot (72") power cord to polarized 2-prong AC plug and 60" lead wire to DC plug and switch cUL/us Listed

## NON DIMMABLE DRIVERS

### MLDR-120-24

Indoor/Outdoor driver  
Max. recommended load 90W per single tap, 120W combined two secondary taps.  
120W hardwire  
Input: 100 - 240V AC  
Output: 24V DC  
10" x 3 3/8" x 3 3/16" (254 x 85.7 x 80.9mm)

### MLDR-20-24JB

Indoor driver  
Max recommended load 18W LED Hard Strip  
Input: 100 - 240V AC  
Output: 24V DC  
20 Watts  
4 1/8" x 4 1/8" x 1 1/2" (104.8 x 104.8 x 38.1mm)