

LED MiniDisc Light

A robust LED marker light ideal for public or residential applications, indoor or outdoor.

FEATURES

- Now dimmable on the primary power supply side with our new dimmable LED Drivers!
- Long life - 50,000 hours
- Low power consumption of 0.24 watts per fixture
- Safe 12 volt, Class 2 power supply (not included)
- Up to 100 fixtures per power supply
- cETLus listed for in-wall, IC ceiling, in-floor, outdoor wet, and outdoor burial applications
- Fits in any 1" diameter hole, 3 1/2" long
- 2 year limited warranty, 3 years on stainless steel

APPLICATIONS

- Steps
- Aisles
- Paths
- Driveways
- Direction lighting
- Information lighting
- Decorative lighting
- Merchandising
- Landscape accents

NOTE: When installing Mini Disc Lights in harsh environments (such as limestone, salted areas, coastal environments, etc.) please use the stainless steel version to avoid the risk of corrosion to the body of the fixture.

PRODUCT CODES

ROUND

LEDMD - XX - YY

LED MiniDisc
Light

COLOUR OF LED

WH - 5400K
WW - 2900K
AM - Amber
BL - Blue
GR - Green
RD - Red

FINISH

AL - Aluminum
WH - White
BZ - Bronze
BK - Black
SS - Stainless Steel

SQUARE

LEDMD - XX - YY - SQ

LED MiniDisc
Light

COLOUR OF LED

WH - 5400K
WW - 2900K
AM - Amber
BL - Blue
GR - Green
RD - Red

FINISH

SS - Stainless Steel



SPECIFICATIONS

Electrical	12V DC, 20mA, 0.24W
Wiring Options	Each LED Driver can power up to 200 LED MiniDisc Lights by parallel wiring ("daisy chain") between fixtures. NOTE: Use LW-18G-CL2 for all in-wall applications. Use LW-18G-BUR for all burial applications.
LED Life	50,000 hours
LED Colours	WH 5400K, WW 2900K, Blue, Green, Amber, Red
Construction	Both cover and barrel are die cast aluminum or stainless steel for corrosion protection, strength, weight and consistency of finish
Cover Finish	Aluminum, White, Bronze, Black, Stainless Steel
Barrel Finish	Aluminum, White, Bronze, Black, Stainless Steel
Lens	Frosted Tempered Glass
Approvals	cETLus listed and labeled for wet, IC, ceiling, wall and direct burial applications.

REPLACEMENT LED MODULES

LCL-LEDMOD-WH

LED Mini Disc Light module, 12V, white LED 5400K

LCL-LEDMOD-WW

LED Mini Disc Light module, 12V, warm white LED 2900K

INSTALLATION WIRE

LW-18G-BUR

For outdoor burial connections

LW-18G-CL2

For indoor through wall connections

NOTE: One of the above wires MUST be used in order to maintain product warranty.

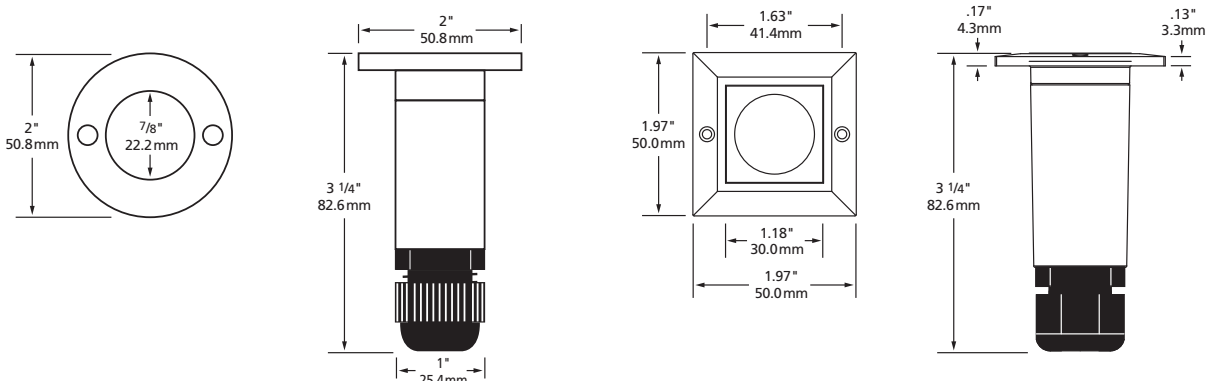

ACCESSORIES



LEDMD-CF

LED MiniDisc Light concrete form for concrete pour applications. Fits over most 1/2" (12.7mm) conduit junction boxes.

LEDMD-CF-SQ

LED MiniDisc Light Square concrete form for concrete pour applications. Fits over most 1/2" (12.7mm) conduit junction boxes.

INDOOR/OUTDOOR DIMMABLE DRIVERS

MLDRE-20-12-DM

20 Watts
 Max. recommended load 18 W or 75 LED MiniDisc Lights
 Min. recommended load 8 W or 34 LED MiniDisc Lights
 6.77" x 2.67" x 1.26" (171 x 68 x 32mm)

MLDRE-60-12-DM

60 Watts
 Max. recommended load 54 W or 200 LED MiniDisc Lights
 Min. recommended load 8 W or 34 LED MiniDisc Lights
 6.77" x 2.67" x 1.26" (171 x 68 x 32mm)

NOTE: For outdoor installations, please add E-KO-SR strain relief.

NON DIMMABLE DRIVERS

LEDDR-12-20W-HW

Indoor driver
 20W hardwire
 Input: 100 - 240V AC; Output: 12V DC
 Max. 75 MiniDisc Lights
 4 1/8" x 4 1/8" x 1 1/2" (104.8 x 104.8 x 38.1mm)

LEDDR-12-60W

Indoor/Outdoor driver
 60W hardwire
 Input: 100 - 240V AC
 Output: 12V DC; Max. 200 MiniDisc Lights
 9 11/16" x 2 9/16" x 2 1/16" (246 x 65 x 52mm)

100% LED Light Output Chart

With every foot of lead wire and every light fixture, there is voltage loss. With too much voltage loss all light fixtures will not develop 100% of their potential output. Below is a chart of acceptable voltage loss which will maintain 100% of the potential light output of the LED MiniDisc Light. Simply plot the number of LED MiniDiscs you wish to place on one lead on the horizontal axis, with the total distance from the LED Driver to the last LED MiniDisc on the vertical axis. If the resulting plot is at or below the line shown, you will have acceptable voltage loss and your LED MiniDisc will output 100% of their potential.

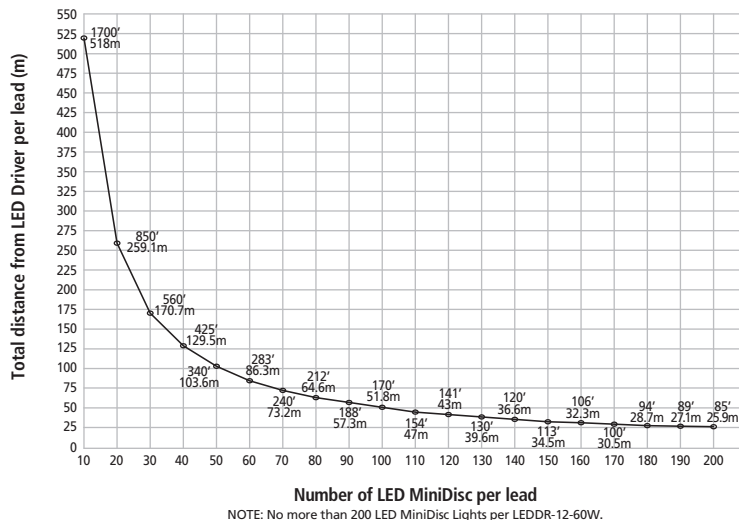

WARNING: LACK OF DRAINAGE WILL VOID THE WARRANTY

To maintain the warranty, a proper drainage system MUST be installed (drainage material or drainage pipe), when the product is installed in soil or concrete.

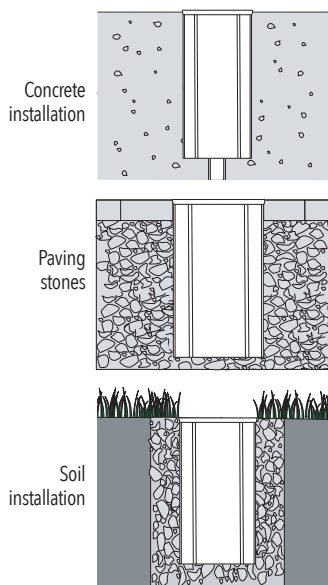

Test drainage prior to installation.

A quantity of water equal to the volume of the mounting hole should drain in 15 minutes or less.

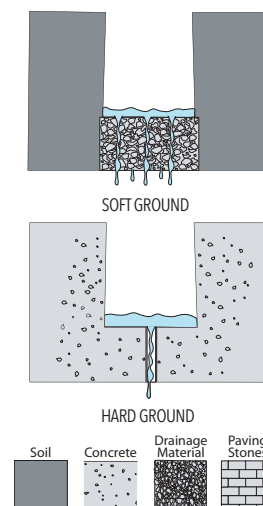

LED MiniDisc Light (Scoop)

LED MiniDisc Scoop is designed to direct light where you want it. Ideal for stair lighting when placed on risers to avoid glare. Great for theatre aisle ways.

FEATURES

- Now dimmable on the primary power supply side with our new dimmable LED Drivers!
- Long life - 50,000 hours
- Low power consumption of 0.24 watts per fixture
- Safe 12 volt, Class 2 power supply (not included)
- Up to 100 fixtures per power supply
- cETLus listed for in-wall, IC ceiling, in-floor, outdoor wet, and outdoor burial applications
- Fits in any 1" diameter hole, 3 1/2" long
- 2 year limited warranty, 3 years on stainless steel

APPLICATIONS

- Steps
- Aisles
- Paths
- Driveways
- Direction lighting
- Information lighting
- Decorative lighting
- Merchandising
- Landscape accents

NOTE: It is not recommended to install Mini Disc Lights Scoop in harsh environments (such as limestone, salted areas, coastal environments, etc.) to avoid the risk of corrosion to the body of the fixture.

PRODUCT CODES

LEDMD - S - XX - YY

LED MiniDisc Light - Scoop	COLOUR OF LED	FINISH
	WH - 5400K	AL - Aluminum
	WW - 2900K	WH - White
	AM - Amber	BZ - Bronze
	BL - Blue	BK - Black
	GR - Green	
	RD - Red	



SPECIFICATIONS

Electrical	12V DC, 20mA, 0.24W
Wiring Options	Each LED Driver can power up to 200 LED MiniDisc Lights by parallel wiring ("daisy chain") between fixtures. NOTE: Use LW-18G-CL2 for all in-wall applications. Use LW-18G-BUR for all burial applications.
LED Life	50,000 hours
LED Colours	WH 5400K, WW 2900K, Blue, Green, Amber, Red
Construction	Both cover and barrel are die cast aluminum or stainless steel for corrosion protection, strength, weight and consistency of finish.
Cover Finish	Aluminum, White, Bronze, Black
Barrel Finish	Aluminum, White, Bronze, Black
Lens	Frosted Tempered Glass
Approvals	cETLus listed and labeled for wet, IC, ceiling, wall and direct burial applications.

REPLACEMENT LED MODULES

LCL-LEDMOD-WH

LED Mini Disc Light module, 12V, white LED 5400K

LCL-LEDMOD-WW

LED Mini Disc Light module, 12V, warm white LED 2900K

INSTALLATION WIRE

LW-18G-BUR

For outdoor burial connections

LW-18G-CL2

For indoor through wall connections

NOTE: One of the above wires MUST be used in order to maintain product warranty.

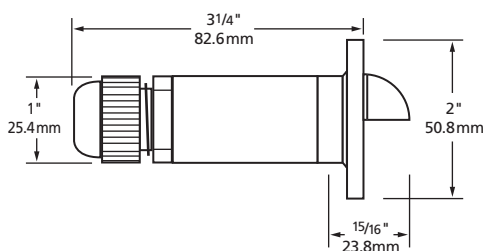
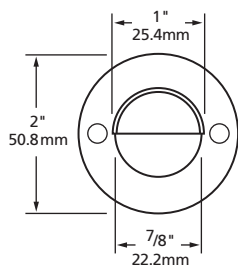

ACCESSORIES



LEDMD-CF

LED MiniDisc Light concrete form for concrete pour applications. Fits over most 1/2" (12.7mm) conduit junction boxes.

100% LED Light Output Chart

With every foot of lead wire and every light fixture, there is voltage loss. With too much voltage loss all light fixtures will not develop 100% of their potential output. Below is a chart of acceptable voltage loss which will maintain 100% of the potential light output of the LED MiniDisc Light. Simply plot the number of LED MiniDiscs you wish to place on one lead on the horizontal axis, with the total distance from the LED Driver to the last LED MiniDisc on the vertical axis. If the resulting plot is at or below the line shown, you will have acceptable voltage loss and your LED MiniDisc will output 100% of their potential.

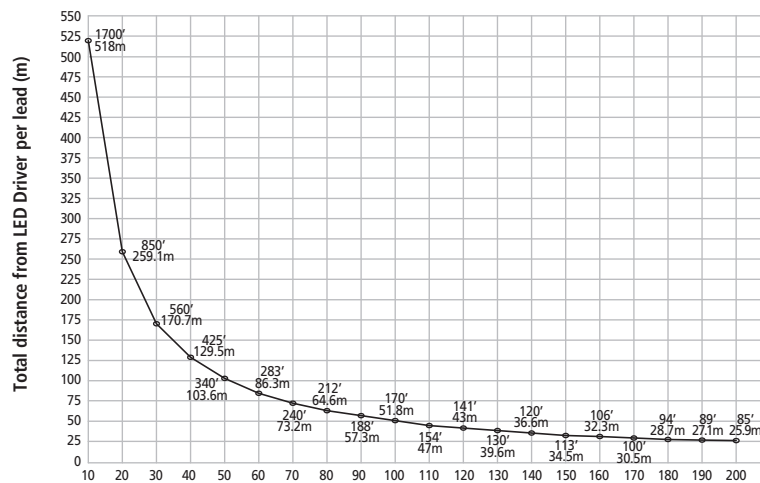

NOTE: No more than 200 LED MiniDisc Lights per LEDDR-12-60W.

INDOOR/OUTDOOR DIMMABLE DRIVERS

MLDRE-20-12-DM

20 Watts
 Max. recommended load 18 W or 75 LED MiniDisc Lights
 Min. recommended load 8 W or 34 LED MiniDisc Lights
 6.77" x 2.67" x 1.26" (171 x 68 x 32mm)

MLDRE-60-12-DM

60 Watts
 Max. recommended load 54 W or 200 LED MiniDisc Lights
 Min. recommended load 8 W or 34 LED MiniDisc Lights
 6.77" x 2.67" x 1.26" (171 x 68 x 32mm)

NOTE: For outdoor installations, please add E-KO-SR strain relief.

NON DIMMABLE DRIVERS

LEDDR-12-20W-HW

Indoor driver
 20W hardwire
 Input: 100 - 240V AC
 Output: 12V DC
 Max. 75 MiniDisc Lights
 4 1/8" x 4 1/8" x 1 1/2" (104.8 x 104.8 x 38.1mm)

LEDDR-12-60W

Indoor/Outdoor driver
 60W hardwire
 Input: 100 - 240V AC
 Output: 12V DC
 Max. 200 MiniDisc Lights
 9 11/16" x 2 9/16" x 2 1/16" (246 x 65 x 52mm)